

## DIP PACKAGING SOCKET .300" HIGH END STACKABLE

### **SPECIFICATIONS**

#### **ENVIRONMENTAL**

Temperature Range: -55°C to +105°C

#### **MECHANICAL**

Insulator Material: Glass-filled polyester, black, UL94V-0

Contact Material: Phosphor Bronze

Contact Plating: See options below

#### **ELECTRICAL**

Current Rating: 1 AMP

Consult factory for additional options

CA-  SE-  SD

POSITION		PLATING
14	16	10 = 10 $\mu$ IN gold
		T = 250 $\mu$ IN tin

DIMENSIONS				
Position	A	B	C	D
14	.698 [17.72]	.600 [15.24]	.300 [7.62]	.395 [10.03]
16	.798 [20.26]	.700 [17.78]	.300 [7.62]	.395 [10.03]

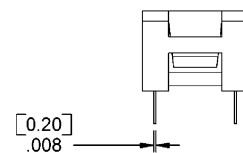
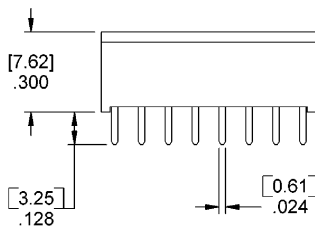
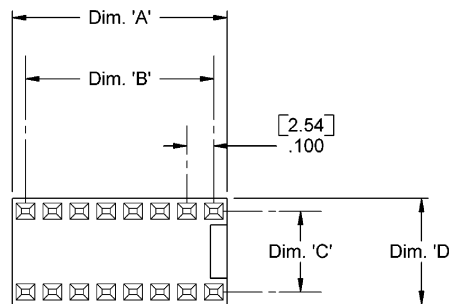

Mating Product: IDPB (page 84), IDP2 (page 85), Dip plugs (page 158)

Drawing Number CA-610216

For more information please contact our customer service department or visit our website at circuitassembly.com

Circuit Assembly Worldwide Hqtrs. 18 Thomas Street, Irvine, CA 92618-2777 USA Tel 1-949-855-7887 Fax 1-949-855-4298