

Pitch: .100" x .100"

INSULATION DISPLACEMENT BOX HEADER, VALUE LINE

SPECIFICATIONS

ENVIRONMENTAL

Temperature Range: -55°C to +105°C

MECHANICAL

Insulator Material: Glass-filled thermoplastic, gray, UL94V-0

Contact Material: Copper Alloy

Contact Plating: Gold Flash

Terminates To: .050" cable, 28 AWG

ELECTRICAL

Current Rating: 1 AMP

Consult factory for additional options

CA- POSITION IDHB- EARS A

POSITION		EARS
10	30	2 = with ears
14	34	3 = without ears
16	40	
20	50	
24	60	
26	64	

DIMENSIONS					
Position	A	B	C	D	E
10	1.45 [36.80]	1.20 [30.50]	.840 [21.30]	.715 [18.16]	.400 [10.16]
14	1.65 [41.90]	1.40 [35.60]	1.04 [26.40]	.915 [23.24]	.600 [15.24]
16	1.75 [44.50]	1.50 [38.10]	1.14 [29.00]	1.015 [25.78]	.700 [17.78]
20	1.95 [49.50]	1.70 [43.20]	1.34 [34.00]	1.215 [30.86]	.900 [22.86]
24	2.15 [54.60]	1.90 [48.30]	1.54 [39.10]	1.415 [35.94]	1.100 [27.94]
26	2.25 [57.20]	2.00 [50.80]	1.64 [41.70]	1.515 [38.48]	1.200 [30.48]
30	2.45 [62.20]	2.20 [55.90]	1.84 [46.70]	1.715 [43.56]	1.400 [35.56]
34	2.65 [67.30]	2.40 [61.00]	2.04 [51.80]	1.915 [48.64]	1.600 [40.64]
40	2.95 [74.90]	2.70 [68.60]	2.34 [59.40]	2.215 [56.26]	1.900 [48.26]
50	3.45 [87.60]	3.20 [81.30]	2.84 [72.10]	2.715 [68.59]	2.400 [60.96]
60	3.95 [100.00]	3.70 [94.00]	3.34 [84.80]	3.215 [81.66]	2.900 [73.66]
64	4.15 [105.40]	3.90 [99.10]	3.54 [89.90]	3.415 [86.74]	3.100 [78.74]

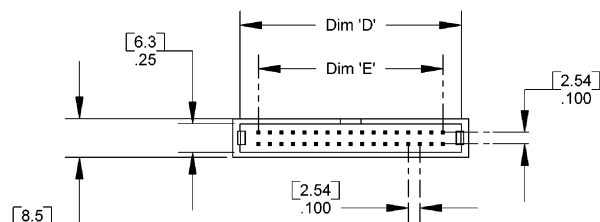
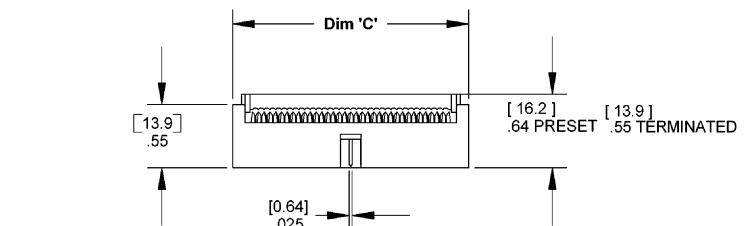

WITHOUT EARS

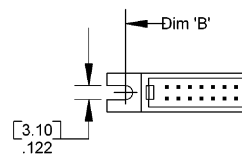
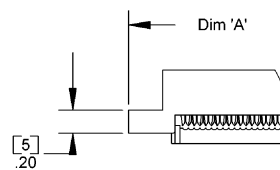

WITH EARS



Mating Product: IDS2, IDS3, FID
Drawing Number: CA-620402